

Description

Sight Flow indicators Cirrus online Sight Flow indicators are commonly used for monitoring of liquid flow in pipelines. They provide visual observation and monitoring of the process flow stream. Having double/single window construction, sight flow indicators are available in various shapes & material of construction. Bodies are made of CS / SS with Toughened borosilicate Glass Windows. Standard units are available in flanged / threaded connections even for higher temperature & pressures.

Sight Glasses - Sight Glasses are designed to be welded on pipelines or side of the vessels for visual observation and monitoring of liquid level/flow inside a tank or pipe. These are custom manufactured as per application with single front windows in various sizes. Sight glasses are universal in application. Their lower flange can be provided with a nozzle to be weld mounted on vessels.

Application: water, condensate, coolant, diesel, solvent, chemicals, alcohol, lube oil, slurries, juices etc.

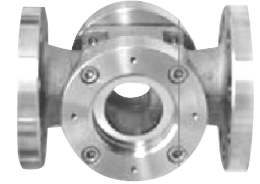
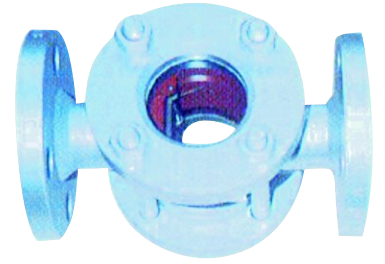

Features

- ⇒ Different construction & sizes, highly economical, versatile used.
- ⇒ Used for major liquids
- ⇒ Toughened glasses

Technical Specification

MODEL	CLI -2 - SF	CLI -2 - SG
Type	Sight Flow indicator	Sight Glass
Sizes	Upto line size 8" / others	Customised
Visibility	Single window / double window	Front window
Connection	Flanged / threaded	Neck / flange
Mounting	Online - pipeline mounting	Welded on tanks
Process Temperature	Upto 200 °C	
Operating Pressure	15 kg / cm2	
Glasses	Toughened borosilicate	

Model Selection

Sight Flow indicators

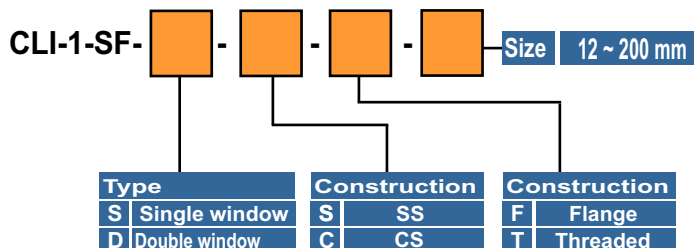

Sight Glasses

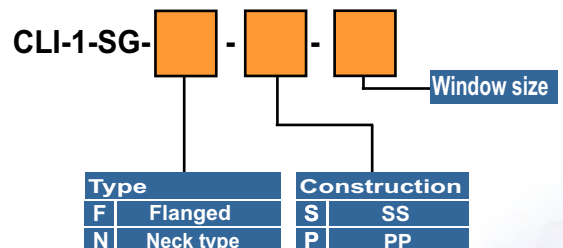

Contact us for other models & specifications not listed here. Due to product enhancement, technical specification may vary.

Cirrus

CIRRUS ENGINEERING & SERVICES PVT. LTD.

A-79, 2nd Floor, Vishal Market,
Tagore Garden Extn.,
New Delhi - 110027

Tel # 011-25176844, 20902218
Fax # 011-25195396
E-mail # cirrusinfo@gmail.com
cirrus@vsnl.net

WWW.CIRRUSINDIA.CO.IN

